

Apparatus Rods

Aluminum Apparatus Rods

Straight, Tapered or Threaded Ends in 1/2" or 3/4" Diameter
Lengths available in 24", 36", 39" and 48"*

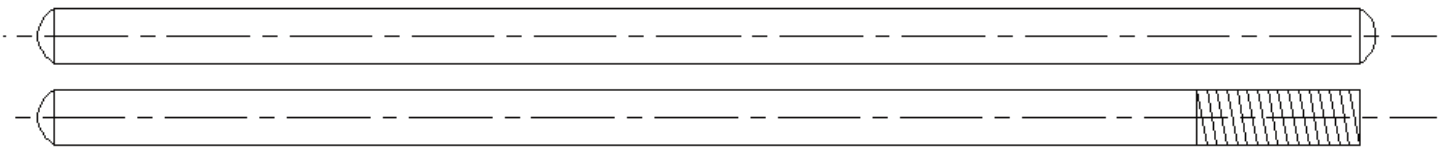

Threaded and Tapered End Connections

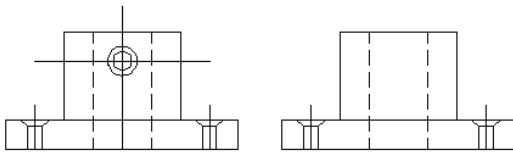

Open and Closed Style Clamps

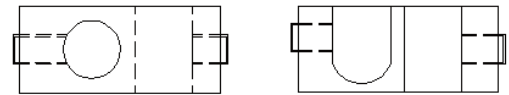

Bench Top and Fume Hood Assemblies Available*

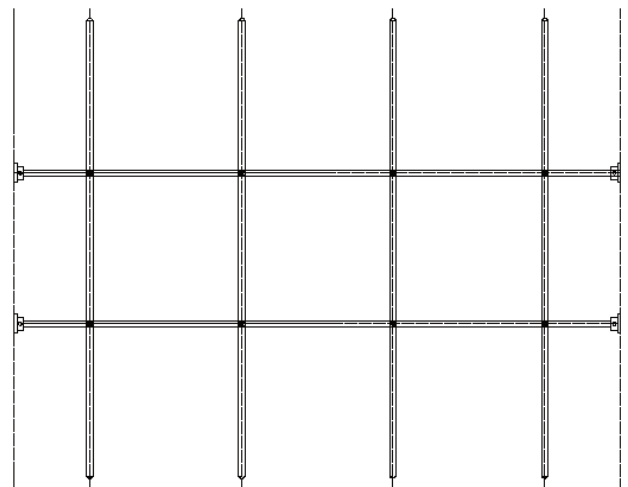
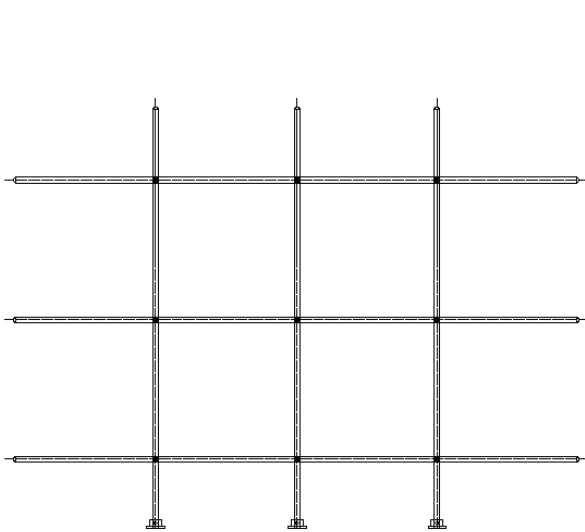

Apparatus Rods

Cross Reference

LAB ENTER. (3/4)	WATERSAVER	DESCRIPTION
SOCKETS		
BSRM-34	AAP100	BURETTE SOCKET FOR RECESS MOUNTING
BSSM-34	AAAP101	BURETTE SOCKET FOR SURFACE MOUNTING
CLAMPS		
AC-34	AAP150	3/4" ADJUSTABLE CLAMP (CLOSED)
VERTICAL RODS (DECK MOUNT)		
VRT-34-024	AAP110-024	3/4" VERT. ROD WITH TAPER ON ONE END 24"
VRT-34-036	AAP110-036	3/4" VERT. ROD WITH TAPER ON ONE END 36"
VRT-34-039	AAP110-039	3/4" VERT. ROD WITH TAPER ON ONE END 39"
VRT-34-048	AAP110-048	3/4" VERT. ROD WITH TAPER ON ONE END 48"
STRAIGHT RODS		
HRR-34-024	AAP155-024	3/4" HORIZ. ROD ROUNDED AT BOTH ENDS 24"
HRR-34-036	AAP155-036	3/4" HORIZ. ROD ROUNDED AT BOTH ENDS 36"
HRR-34-039	AAP155-039	3/4" HORIZ. ROD ROUNDED AT BOTH ENDS 39"
HRR-34-048	AAP155-048	3/4" HORIZ. ROD ROUNDED AT BOTH ENDS 48"
 (1/2")		
FLANGES		
AF-12	AAP158	1/2" ROD ADJUSTABLE FLANGE WITH SET SCREW
AFT-12	AAP158A	1/2" ROD FLANGE WITH THREAD
CLAMPS		
ACC-12	AAP151	1/2" ADJUSTABLE CLAMP (CLOSED STYLE)
ACO-12	AAP153	1/2" ADJUSTABLE CLAMP (OPEN STYLE)
THREADED END RODS		
VRT-12-008	AAP125-008	1/2" ROD THREADED ON ONE END 8"
VRT-12-010	AAP125-010	1/2" ROD THREADED ON ONE END 10"
VRT-12-012	AAP125-012	1/2" ROD THREADED ON ONE END 12"
VRT-12-018	AAP125-018	1/2" ROD THREADED ON ONE END 18"
VRT-12-024	AAP125-024	1/2" ROD THREADED ON ONE END 24"
VRT-12-036	AAP125-036	1/2" ROD THREADED ON ONE END 36"
PLAIN END ROD		
VHR-12-005	AAP145-005	1/2" ROD ROUNDED AT BOTH ENDS 5"
VHR-12-008	AAP145-008	1/2" ROD ROUNDED AT BOTH ENDS 8"
VHR-12-010	AAP145-010	1/2" ROD ROUNDED AT BOTH ENDS 10"
VHR-12-012	AAP145-012	1/2" ROD ROUNDED AT BOTH ENDS 12"
VHR-12-018	AAP145-018	1/2" ROD ROUNDED AT BOTH ENDS 18"
VHR-12-024	AAP145-024	1/2" ROD ROUNDED AT BOTH ENDS 24"
VHR-12-036	AAP145-036	1/2" ROD ROUNDED AT BOTH ENDS 36"
VHR-12-048	AAP145-048	1/2" ROD ROUNDED AT BOTH ENDS 48"
VHR-12-060	AAP145-060	1/2" ROD ROUNDED AT BOTH ENDS 60"
VHR-12-072	AAP145-072	1/2" ROD ROUNDED AT BOTH ENDS 72"
VHRA-12	AAP120	ADAPTER FOR 1/2" VERTICAL MEMBER